

3 YEARS WARRANTY
PARTS & LABOR

SPIKA NG 175

115 V / 60 Hz

SELF-CONTAINED ICE CUBE MACHINE

FEATURES

- ▶ PRODUCES FULL DICE ICE CUBES OR HALF DICE ICE CUBES
- ▶ STIF: STRONG INOX FRAME. SOLID MACHINE STRUCTURE IN 4 COLUMNS WITH AISI 304 STAINLESS STEEL FRAME
- ▶ STRONGEST DOOR IN THE MARKET. MADE OF STAINLESS STEEL. OPENING AND DAMPING SYSTEM PATENTED BY ITV.
- ▶ FRONT VENTILATION CONCEPT: FRONTAL IN-OUT AIR SYSTEM ALLOWS 'BUILT IN' MACHINES
- ▶ CLEANING SWITCH: ALLOWS CIRCULATION OF WATER WITH DESCALING PRODUCT (CALKIN OR SIMILAR) WITHOUT COOLING.
- ▶ "NEVER STOP" MOTOR PUMP DEVELOPED BY ITV. PUMP WITHOUT SEALS, WHICH AVOIDS DETERIORATION IN HARD WATER
- ▶ EASI: EASY ACCESS FOR SERVICE & INSTALLATION. ALL PANELS CAN BE DISASSEMBLED SEPARATELY.
- ▶ ON/OFF LIGHTED ROCKER SWITCH IN FRONT PANEL
- ▶ TROPICALIZED MACHINES (T CLASS) / HEIGHT ADJUSTABLE LEGS FROM 37" TO 39"



	24 H	70°F/21°C	50°F/10°C	90°F/32°C	70°F/21°C	STOCK	in (mm)	in (mm)	SPIKA HALF DICE 0,9" (W) x 0,4" (D) x 1" (H) 23 mm (W) x 11 mm (D) x 26 mm (H) Average dimensions
SPIKA NG 175 A		192 (87)		157 (71)		77,2 (35)	Width 26" (660)	Width 29" (745)	SPIKA FULL DICE 1" (W) x 0,9" (D) x 1" (H) 26 mm (W) x 23 mm (D) x 26 mm (H) Average dimensions
SPIKA NG 175 W		192 (87)		157 (71)			Depth 28" (700)	Depth 30" (770)	
							Height* 33" (838)	Height 38" (970)	

* WITH LEGS 37"/39"

ACCESSORIES

INCLUDED



WATER OUTLET HOSE



4 HEIGHT ADJUSTABLE LEG KIT



SCOOP

NOT INCLUDED (OPTIONAL)



10" FILTER
ANTI-LIMESCALE + ANTI-CHLORINE
CS-102 K



10" REPLACEMENT CARTRIDGE
ANTI-LIMESCALE + ANTI-CHLORINE
CS10



SCALE KLEEN

TECHNICAL SCHEME

SPIKA NG 175

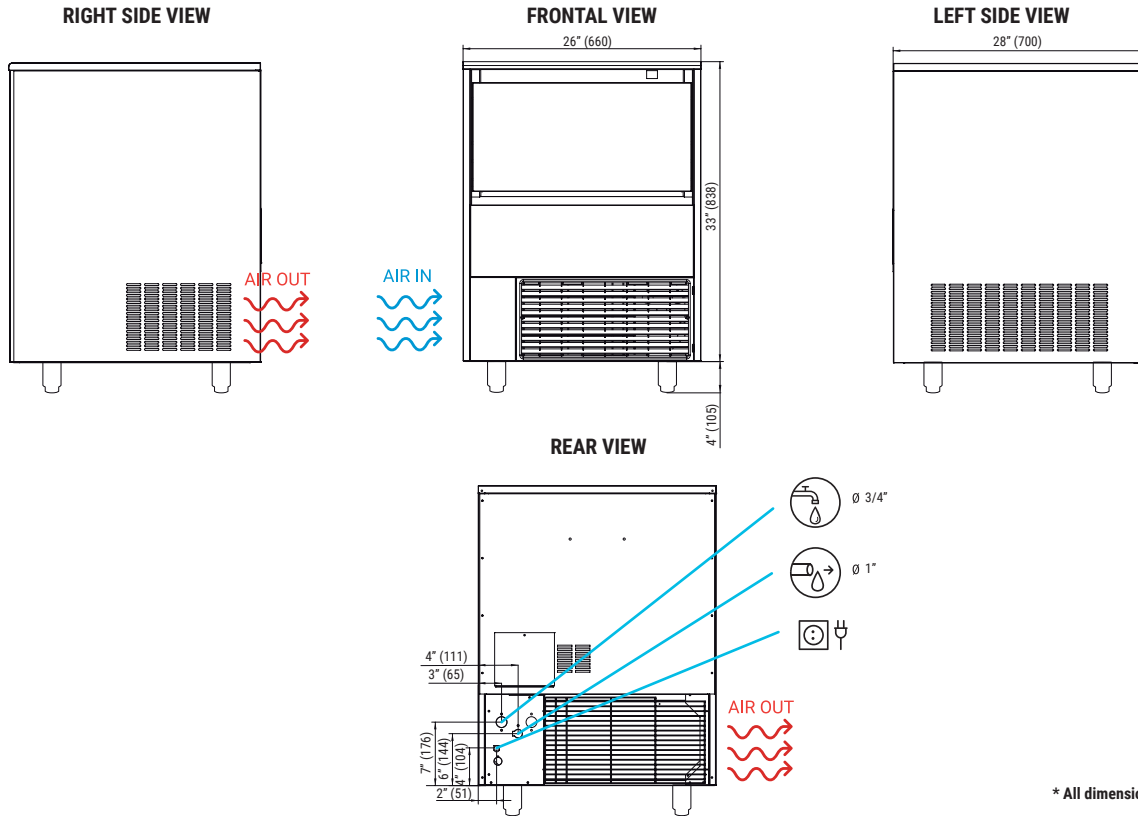

* All dimensions in inches (and mm)

OPERATING CONDITIONS

PRODUCTION (LBS) 60Hz

±10% V

41°F/109°F

41°F/95°F

14.5 psi (1 bar) / 87 psi (6 bar)

120/240 Ice cubes/cycle

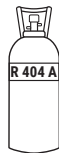

V	Hz	ph
115	60	1N

FULL DICE

SPIKA NG 175 AIR COOLED

	50° 10°	60° 15°	70° 21°	86° 30°
50° 10°	200	191	178	160
68° 21°	192	182	169	150
90° 32°	183	171	157	137
109° 43°	170	158	144	123

FULL DICE

SPIKA NG 175 WATER COOLED

	50° 10°	60° 15°	70° 21°	86° 30°
50° 10°	200	191	178	160
68° 21°	192	182	169	150
90° 32°	183	171	157	137
109° 43°	170	158	144	123

MODELS

	(BTU/h)	(W)	(W) 109°F	(AWG/mm ²)	(n.)	FUSE	100lbs 90°F / 70°F (Kwh/100 lbs)	gal 100lbs (l/h)	HEAT REJECTED (BTU/h) (W)	(lbs)	(lbs)		
SPIKA NG 175 A	4,299	1,260	573	14/1.5	3	15	8.3	29.5	9	3,532	1,035	150	179
SPIKA NG 175 W	4,299	1,260	573	14/1.5	3	15	6.1	129.3	37.9	3,532	1,035	150	179



ITV Ice Makers, Inc.
9550 Satellite Blvd, Suite 100
Orlando, FL 32837
Phone: 1 407 826 1860 | Fax: 1 407 826 1861
Toll Free: 1 888 488 1423
sales@itvice.com | www.itvice.com



SERVICE
service@itvice.com
Skype: service@itvice.com
PHONE: +1 888 488 1423
FROM 8AM TO 5PM EST



2 ADDITIONAL YEARS ON COMPRESSOR & EVAPORATOR
Read our warranty policy to know more about limitations and exclusions

